

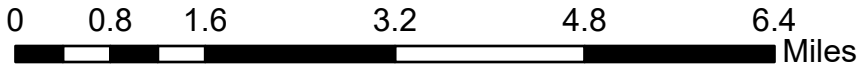

# Volunteer Wildlife Monitoring Program (VWMP) Frog and Toad Survey

Inactive Route Map Route ID: 360222 County: Taylor

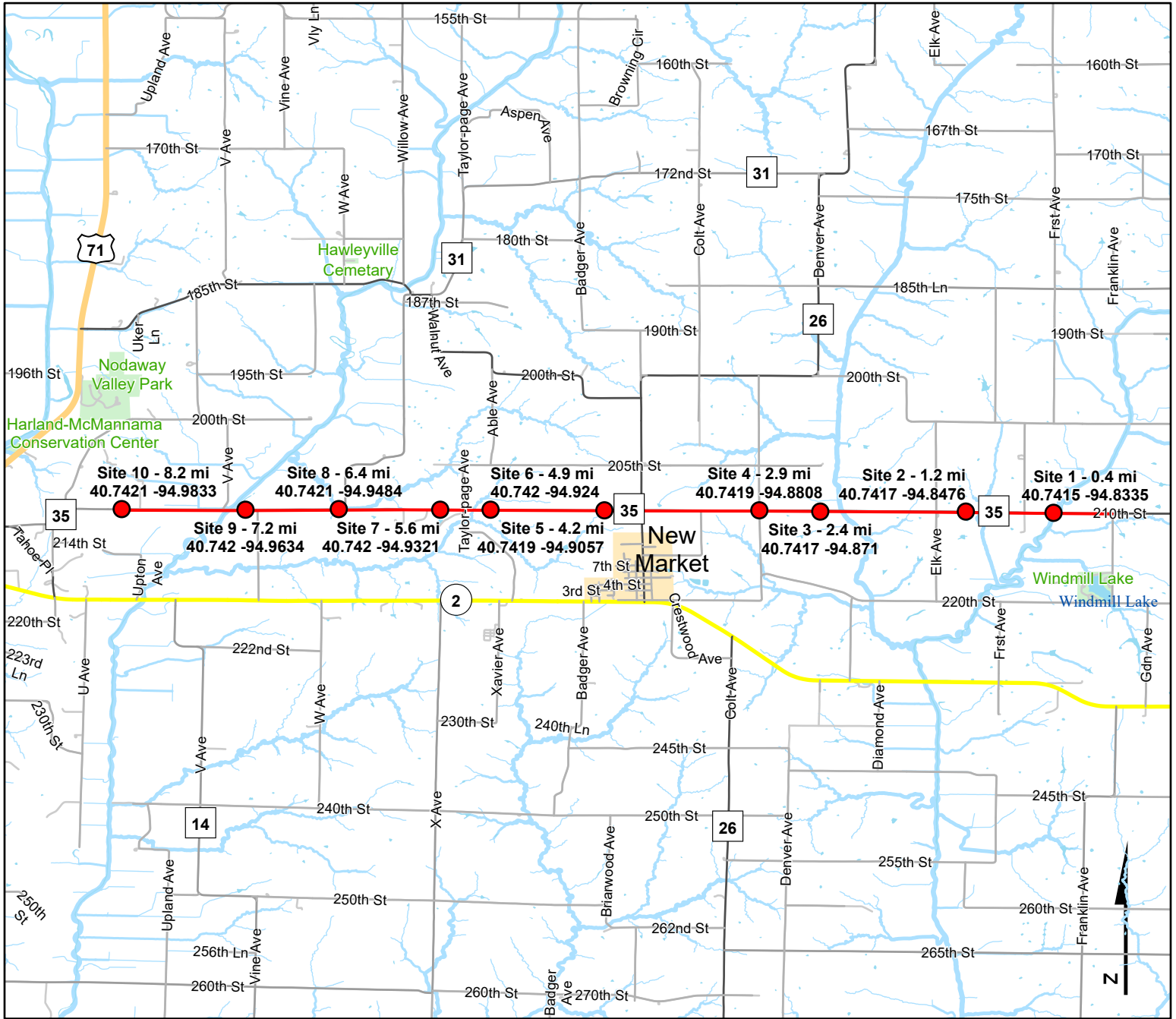

- Frog and Toad Survey Sites
- Frog and Toad Survey Route



Questions? Contact the VWMP Coordinator at [vwmp@dnr.iowa.gov](mailto:vwmp@dnr.iowa.gov).  
Created on: 4/4/2019

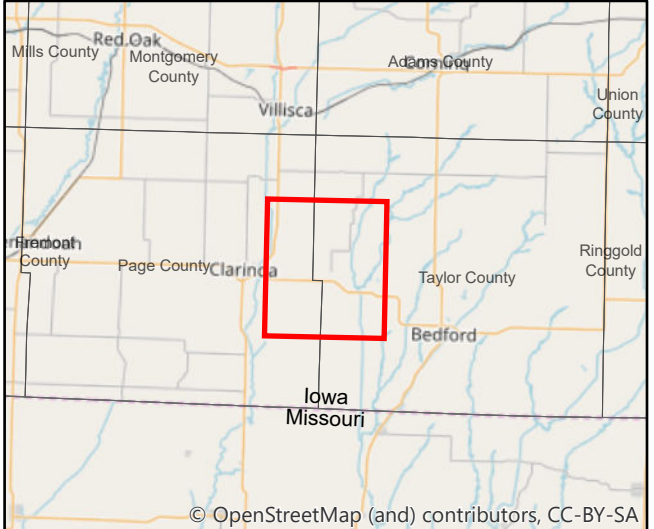



# Volunteer Wildlife Monitoring Program (VWMP) Frog and Toad Survey

Inactive Route Table      Route ID: 360222      County: Taylor



SiteNum	Site_Name	Directions
1	0.4	Drive 0.4 miles west from start at Franklin and J35. Stop on west side of bridge- stagnant marshy water area on right side of road.
2	1.2	Continue driving west on J35. Cross over low point in road with stream and pull into 1st field pull off on right as you head up hill. Tree lined stream and flooded field/pond.
3	2.4	Continue west. Cross bridge over 102 river - go~ 100 yards to pasture pull-off on left. There's a small farm pond in the pasture and a deep ditch holding water.
4	2.9	Continue west. Stop at intersection with crestwood. Several pasture ponds in vicinity.
5	4.2	Continue west onto gravel. Stop at the bottom of the hill - grassed waterway and stream in ditch on right. Tree-lined on left.
6	4.9	Continue west. Pass 2 ponds on the right hand side and stop at 3rd pond on left surrounded by willows and other trees. Rusted electrical box.
7	5.6	Continue west. Large pond in bowl left -in pasture.
8	6.4	Continue west. Stop at intersection with Willow. Slow moving creek.
9	7.2	Continue west. Stop just after passing V ave. and before you cross bridge. Marshy area on both sides of road.
10	8.2	Continue west. Stop is by pond on left next to small feed lot. Just past house with Wilson's Seeds sign.